



PLEASE READ BEFORE USE

1 Getting Started

Welcome

Thank you for purchasing a Uniden phone.

NOTE : Illustrations in this manual are used for explanation purposes. Some illustrations in this manual may differ from the actual unit .

Features Review

- FSK/DTMF Caller ID*
- Speakerphone
- 50 Incoming Calls memories
- 10 Outgoing Calls memories
- 10 One Touch Memories
- Mute function
- Message Waiting Lamp
- Wall Mountable
- Redial
- On-hook pre-dialing
- Headset
- Flash timing selectable
100ms/300ms/600ms/1000ms
- LCD Contrast Adjustable

*Caller ID requires subscription to your local telephone company.

Accessories(included)

- | | |
|---|--|
| <input type="checkbox"/> 1. Base unit.....one | <input type="checkbox"/> 2. Handset.....one |
| <input type="checkbox"/> 3. Telephone line cord.....one | <input type="checkbox"/> 4. Handset cordone |
| <input type="checkbox"/> 5. User manualone | <input type="checkbox"/> 6. Headset (not included) |

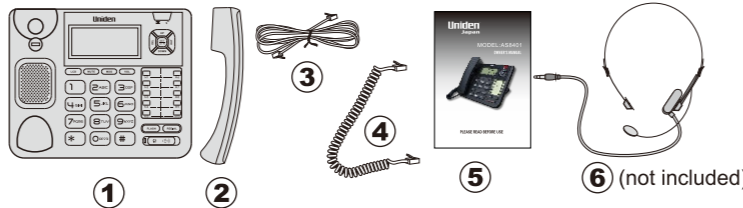

NOTE: If you find any of the parts missing, please contact your local shop where you buy this product at once.

4 Phone Basics

Redial

If you get a busy tone when dialing, pressing the REDIAL button will automatically redial the last number you dialed.

Flash

During conversation, pressing Flash button will momentarily interrupt the telephone conversation to access telephone company services.

Receiving Incoming Call

The unit will display the caller's telephone number on the display. Please make sure you have subscribed to your local telephone company for the Caller ID service.

NOTE: Your Caller ID phone stores and displays specific information, provided by your local telephone company, to subscribers of Caller ID or similar caller identification services.

Delete Button

Pressing this DEL button during incoming and outgoing Caller ID review will delete the number shown from the record.

On-Hook Pre-Dialing

User can enter the telephone number first and check the number to be dialed, like reviewing the incoming or outgoing records, before picking up the handset or pressing the Speakerphone button will dial out the displayed number.

Wall mounting

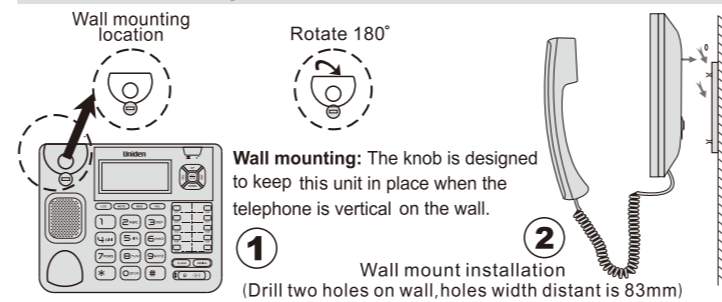

LCD display layout

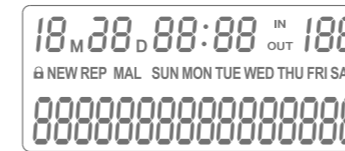

- | | |
|-------------------------------|-----------------------------|
| 1 18:38:88 | Date, time |
| 2 IN | Incoming call |
| 3 OUT | Outgoing call |
| 4 NEW REP MAIL | Repeat ,new call,mail, lock |
| 5 8888888888888888 | Phone number display |
| 6 SUN MON TUE WED THU FRI SAT | Week display |

2 Setting

Setting flow Layout

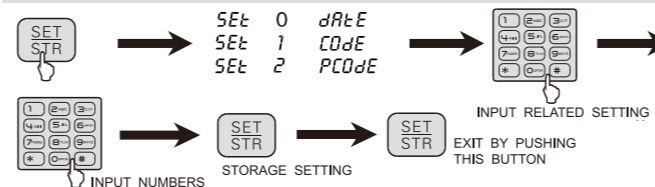

4 Phone Basics

Reviewing Incoming and Outgoing Calls

Press [UP] or [DOWN] button to review incoming call. This telephone unit is capable of storing up to 50 incoming calls. When 50 records are reached new calls will be recorded and old calls will be deleted automatically.

Press [OUT] button to enter outgoing calls reviewing state. Press [OUT] button again to review outgoing calls. During the reviewing of your incoming or outgoing record, press [SPEAKERPHONE] button or picking up the handset will dial out the displayed telephone number.

Mute Function

While off-hook , pressing the MUTE button will prevent the other party from hearing you. Pressing it again will resume normal conversation.

Pause

Press [REDIAL] button to insert a delay pause time

Using PABX Code

When PABX Code is set, dialing a 6-digit number or more as shown on the telephone display will automatically insert the PABX Code to the front of your number when the telephone is diali

NOTE: If your telephone number begins with 0, please keep the phone in the unlocked state.

Voice Message

Use the number keypad to enter voice message service number and then press [MSG] for 3 seconds when unit displays"SAVE".

Message Waiting Lamp Function

When the message waiting lamp is flashing, this mean voice message left.

In off-hook mode.

Press [MSG] button to listen the message.

2 Setting

Setting Date and Time

IMPORTANT: On-hook press [SET/STR] for starting to set up any function , LCD will display SET 0123 then press 0...3 to enter required function you wish to set up, also press SET to confirm after completion of any set up and press DEL to return previous menu or edit any digit.

1. Press [SET/STR] button until [0123] appears, then press [0] to enter DATE and TIME setting mode
2. Time setting, e.g: 17:20:00 (hr:min:sec), enter [1][7][2][0][0][0] then press [SET/STR] button to save
3. Date setting, e.g: 2014/06/19, enter [2][0][1][4][0][6][1][9], then press [SET/STR] button to save.

Setting Local Area Code

The Local Area Code setting allows up to a maximum of 6-digit code. After setting the Local Area Code, incoming call within your telephone exchange area will automatically be filtered to remove the Local Area Code that matches.

1. Press [SET/STR] button until "0123" appears, then press [1] to enter LOCAL AREA CODE setting mode.
2. Then the displays " CODE ----" (not programmed) or programmed local area code.
- The first digit of the area code flashes.
3. Press 0-9 to modify it
4. When finished the digit edit, press [SET/STR] button to save.

Setting PABX Code

The PABX code setting allows up to a maximum of 3-digit external line access code. Make sure the unit is not locked.

1. Press [SET/STR] button until "0123" appears, then press [2] to enter PABX Code setting mode.
2. Then the display shows "PCODE----" (not programmed) or programmed PABX code the first digit of PABX code flashes.
3. Press [0].....[9] to modify it.
4. When finished the digit edit, press [SET/STR] button to save

Ringer Volume Level

You may select ringer volume level on high, low, or off.

Handset or Speakerphone Volume

You may adjust speakerphone volume level during conversation by Press [VOL] button to adjusting handset or speakerphone volume from level 1 to level 4.

5 Troubleshooting

No dial tone

- Check all cabling to make sure that all connections are secure and not damaged .
- Ensure the telephone line cord is securely connected to the modular jack .
- Connect another phone to the same modular jack . If it does not work , the problem might be your wiring or local service .
- Use another telephone line .

Incoming voice too low or none at all

- Check and adjust volume control setting .

No Caller ID

- Make sure you have subscribed to the Caller ID service from your local telephone Company

Flash Time Setting

Flash time setting Default setting 600ms.

To set flash time,

In off-hook mode (left handset):
Press *#+Flash time (100/300/600/1000ms) and then press [FLASH] button .

E.g: To set 100ms, press *#+100+[FLASH] button.

Pause Time Setting

To set pause time,

In off-hook mode (left handset):

Press *#+(1...3)+*# and then press [REDIAL] button .

Pause time 1=1.2s/2=2.4s/3=3.6s

E.g: To set 3.6s, press *#+3+*[REDIAL] button.

Message Waiting Lamp Switch

1. The HV setting for residential use only
2. The PR1 and PR2 setting for pabx use only

LCD Brightness Adjust Function

1. Under standby, press [LCD], LCD displays [LCD3].
2. Press [LCD] button adjust LCD brightness, 5 LCD level adjustable.

3 Memory

Memory Store

You can store a number up to 32 digits in 10 one-touch memory [M1]----[M10].

One-touch Memory Store

Use the number keypad to enter the telephone number you want to store (up to 32 digit) and then press [M1].....[M10] for 3 seconds when unit displays "SAVE"

Memory Delete

Press **+[M1].....[M10] for 3 seconds

3 Memory

Memory Dialing

One-touch DIAL:

In On-hook mode:

1. Press [M1].....[M10] button.
2. Go Off-hook or press Speakerphone button or DIAL button then the phone number stored in the location can be dialed out .

In Off-hook mode:

1. Press [M1].....[M10] button, the phone number stored in the location can be dialed out directly .

Updating the call number in memory

Repeat one-touch memory store operation to update the new phone number.

Speakerphone Operation

Pressing Speakerphone button will activate speaker operation.

Pressing Speakerphone button again will hang-up the call. During Speakerphone conversation, picking up handset will automatically switch the conversation to the handset.

Headset Operation

The headset operation is the same as the speakerphone operation. When the headset is plugged in, pressing the SPEAKER button will take line and activate the headset. Conversation can begin using the headset. Pressing the SPEAKER button again will release the line and deactivate the headset.

During headset conversation, picking up the handset will automatically transfer the conversation to handset. Returning the handset after conversation will release the line.

Using the Headset Feature

Your **HANDSET**, when connected to a headset (not included), will provide you with hands-free communication. Use on!

Headset jack specification-3.5mm connector. (compatible to **Panasonic** Headset)

6 Safety Instructions

Take special care to follow the safety suggestions listed below . Please do not use telephone during thunderstorm.

Installations Environment

1. Avoid putting the phone near heating appliances and devices that generate electrical noise (for example, motors or fluorescent lamps).
2. Do NOT expose to direct sunlight or moisture.
3. Do not install the telephone during thunderstorm.
4. Clean the phone with a soft cloth.
5. Never use a strong cleaning agent or abrasive powder because this will damage this unit.
6. Avoid dropping the handset , as well as other rough treatment to the phone.

Placement

1. Do not place heavy objects on top of this unit .
2. Care should be taken so that objects do not fall onto, and liquid into , the unit . Do not subject this unit to excessive smoke , dust, mechanical vibration or shock .

WARNING : To prevent fire or shock hazard , do not expose this product to rain or any type of moisture.